

T-PLAST

PP COMPRESSION FITTINGS AND
VALVES FOR TRANSITIONS
ACCESORIOS DE COMPRESIÓN
Y VÁLVULAS DE PP PARA TRANSICIONES



Information / Información

The advantages of the T-Plast fittings, combine with the versatility of the WRAS KIT that adapts to any type of material up to diameter 50mm-1 ½" and a working pressure up to PN16 (Lead PN10).

All this makes it an indispensable accessory in water supply companies for renovation and maintenance of the pipelines.

With few elements of simple application, the majority of repairs can be performed without knowing previously the condition of the pipe, with the consequent saving of time and money.

A las ventajas de los accesorios T-PLAST, se une la versatilidad del KIT WRAS que se adapta a cualquier tipo de material hasta 50mm-1 ½" y una presión de hasta PN16 (Plomo PN10).

Todo ello lo convierte en un accesorio indispensable en compañías de agua para operaciones de renovación y mantenimiento de tuberías.

Con pocos elementos de simple aplicación, se pueden realizar la mayoría de intervenciones sin necesidad de conocer la situación previa, con el consiguiente ahorro de tiempo y dinero.

Applications / Aplicaciones

Pipelines / Tuberías

PE40, PE50, PE80, PE100, PVC, Imperial PE, Galvanized Iron, Lead, Copper, etc. Polyethylene pipes of high, medium or low density.

Tuberías de polietileno de alta, media o baja densidad PE40, PE50, PE80, PE100, PVC, Imperial PE, Hierro Galvanizado, Plomo, Cobre, etc.

Working conditions / Condiciones de trabajo

- Maximum temperature: 80 ° C
- Rated pressure PE:
16 Atm (PN16) at 20 ° C to Ø63
10 Atm (PN10) at 20 ° C from Ø75
- Rated Universal Pressure: 16 Atm (PN16)

- Temperatura máxima: 80 ° C
- Presión nominal PE:
16 Atm (PN16) a 20°C hasta Ø63
10 Atm (PN10) a 20°C a partir de Ø75
- Presión nominal Universal: 16 Atm (PN16)

Range of application / Rango de aplicación

For PE From DN16 to DN63
Other pipes, from 15mm (1/2 ") to 50mm (1 1/2 ")

- Ø15-21 3/8 "to 1/2"
- Ø21-27 1/2 "to 3/4"
- Ø27-35 3/4 "to 1"
- Ø35-50 1 1/4 "to 1 1/2"

Drinking water systems, any kind of irrigation systems, fertilizing included, gardening, agriculture, canalization for alimentary fluids (wine, beer, beverage,), wastewater treatment, mining, swimming pools with fresh or sea water, industry, telecommunications, ...

Para PE Desde DN16 a DN63
Otras tuberías, desde 15mm (1/2") hasta 50 mm (1 1/2")

- | | |
|----------|-----------------|
| - Ø15-21 | 3/8" a 1/2" |
| - Ø21-27 | 1/2" a 3/4" |
| - Ø27-35 | 3/4" a 1" |
| - Ø35-50 | 1 1/4" a 1 1/2" |

Acometidas de agua potable, tomas de abonado, instalaciones de riego, jardinería, agricultura, canalizaciones de uso alimentario (vino, cerveza, bebidas, ...) depuración de aguas, minería, piscinas de agua dulce o salada, industria, telecomunicaciones, etc.

Shapes / Figuras

VALVES

Compression PE- Universal, universal compression-BSP/NPT thread (female or male).



VÁLVULAS

Compresión PE- Universal, compresión Universal-Rosca BSP/NPT (hembra o macho).



Materials / Materiales

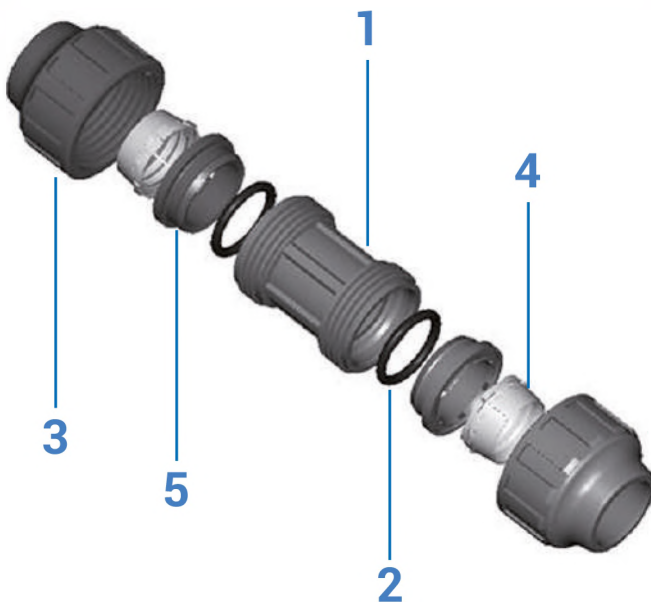

1. Body and nut / Cuerpo y tuerca :
Polypropylene / Polipropileno

2. O-ring / Juntas tóricas:
Rubber / Caucho

3. Compression ring / Casquillo de apriete :
Polypropylene / Polipropileno

4. Grip ring / Bicono de agarre :
Polyacetal Resin / Resina acetálica

5. Nut / Tuerca: Polypropylene / Polipropileno

INFO: All female threaded parts are reinforced with metal ring in stainless steel./ Todas las piezas rosca hembra van reforzadas con aro metálico en acero inoxidable.

Materials / Materiales

ANY METALIC OR PLASTIC PIPE (15MM - 1/2" - 50MM - 1 1/2")
UNIÓN DE CUALQUIER TUBERÍA METÁLICA O DE PLÁSTICO (15mm - 1/2" a 50 mm - 1 1/2")

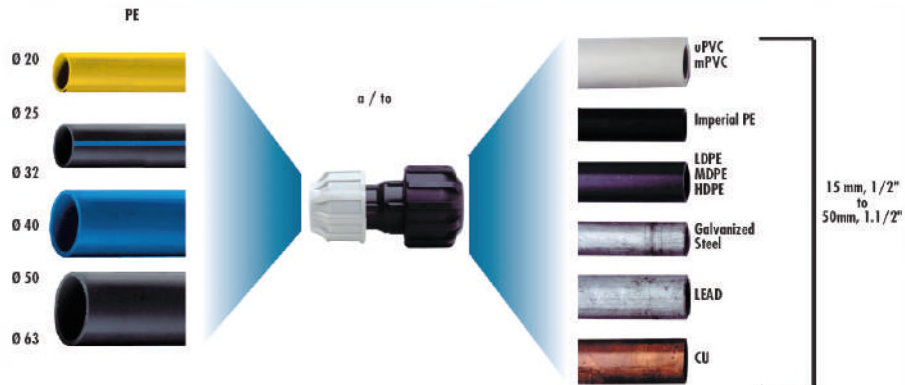

Universal kit pn16 (Lead pn10) / Kit universal pn16 (Plomo pn10)

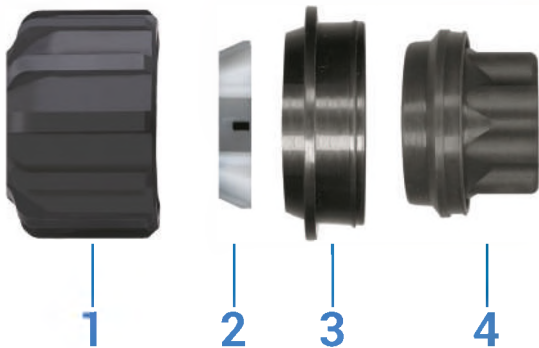

Component / Componente	Material
1 Compression Nut / Tuerca de compresión	polypropilene / polipropileno
2 Slip ring / Bicono universal	polyacetal resin / resina acetálica
3 Compression ring / Casquillo	polypropilene / polipropileno
4 Universal ruber / Junta universal	rubber / caucho

Assembly method / Sistema de montaje

T-Plast fittings and valves assembly is fast and easy; use of any special tools is necessary. Anyway, is recommended use of an articulated hook wrench, pretty often employed by installers. STPACUSTER GROUP has his own range of the hook wrenches, designed especially for ours fittings.

El montaje de las válvulas y accesorios T-PLAST es fácil y rápido ya que no se precisan herramientas o útiles especiales, aunque se recomienda el uso de llaves de gancho articulado, elementos muy usados por los instaladores. STPACUSTER GROUP tiene sus propias llaves de apriete, especialmente diseñadas para nuestros accesorios.

For installation of the PE part, follow the assembly instructions for the PLAST accessories.
Para la instalación de la parte de PE, seguir las instrucciones de montaje de los accesorios PLAST.

FOR THE INSTALLATION OF THE UNIVERSAL PART WITH THE WRAS KIT:

1) Release (unscrew) the nut near 2 full turns and insert the pipe through the compression ring, grip ring and the rubber to the bottom of itself. **DO NOT FORCE THE RUBBER BOTTOM.**

2) Screw the nut using two wrenches, clamping the nut and the body, til the employed force will be substantial. Considering that the measures are variable, there's not definitive end of screwing.

3) Attempt to leave the pipe completely straight respect the body.
Note: is recommended, as for any installation, apply a dummy pressure (for example: 5 Bars) into the pipeline, abort and tighten again, before employing the final working pressure.

PARA LA INSTALACIÓN DE LA PARTE UNIVERSAL CON EL KIT WRAS:

1) Aflojar (desenroscar) la tuerca unas 2 vueltas y hacer pasar el tubo a través del bicono, casquillo y junta universal hasta el tope de ésta. **NO FORZAR DICHO TOPE.**

2) Ir roscando la tuerca con 2 llaves, sujetando la tuerca y el cuerpo, hasta que la fuerza a efectuar sea considerable. Teniendo medidas variables, no se nota un final de roscado concreto.

3) Procurar que el tubo quede recto respecto al cuerpo.
Nota: se recomienda, como en cualquier instalación, dar una primera presión (ejemplo: 5 Bares) al conjunto, quitarla y reapretar, antes de dar la presión de uso definitivo.

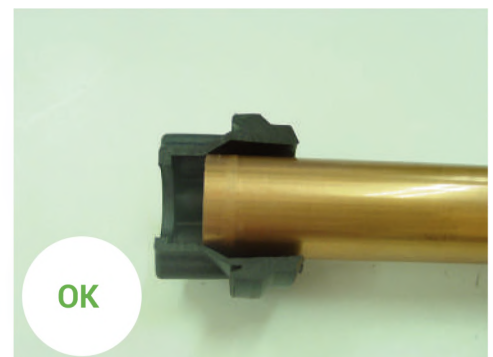

Fittings & valves / Accesorios y valvulas

Mesured in mm / Medidas en mm

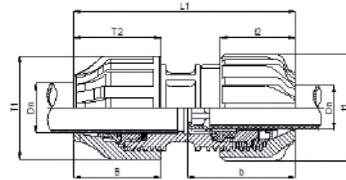

**UNIVERSAL TRANSITION COUPLING /
MANGUITO TRANSICION UNIVERSAL**

CODE	Dn	dn	L1 (max/min)	T1	T2	B	t1	t2	b (max)
ST716016	16	15-21 (3/8"-1/2")	109,5/116,5	47	40,2	51	55	44	58
ST716020	20	15-21 (3/8"-1/2")	109,5/116,5				55	44	58
ST716025	25	15-21 (3/8"-1/2")	115,5/122,5	54	46	57	55	44	58
ST716032	32	15-21 (3/8"-1/2")	118,5/125,5	64,5	49	61	55	44	58
ST716040	40	15-21 (3/8"-1/2")	134,5/141,5	80	58	76	55	44	58
ST717020	20	21-27 (1/2"- 3/4")	112,0/119,5	47	40,2	51	64,5	49	61
ST717025	25	21-27 (1/2"- 3/4")	134,0/141,5	54	46	57	64,5	49	61
ST717032	32	21-27 (1/2"- 3/4")	123,0/130,5	64,5	49	61	64,5	49	61
ST717040	40	21-27 (1/2"- 3/4")	144,0/151,5	80	58	76	64,5	49	61
ST717050	50	21-27 (1/2"- 3/4")	152,5/160	94	70	92	64,5	49	61
ST718025	25	27-35 (3/4 - 1")	124,0/138,5	54	46	57	80	55	74,5
ST718032	32	27-35 (3/4 - 1")	134,0/148,5	64,5	49	61	80	55	74,5
ST718040	40	27-35 (3/4 - 1")	144,0/158,5	80	58	76	80	55	74,5
ST718050	50	27-35 (3/4 - 1")	159,0/173,5	94	71	92	80	55	74,5
ST718063	63	27-35 (3/4 - 1")	180,0/194,5	117	86	103,5	80	55	74,5
ST719032	32	35-50(1 1/4"-1 1/2")	147,0/164,5	64,5	49	61	95	85	108
ST719040	40	35-50(1 1/4"-1 1/2")	163,5/181,0	80	58	76	95	85	108
ST719050	50	35-50(1 1/4"-1 1/2")	180,5/198,0	94	71	92	95	85	108
ST719063	63	35-50(1 1/4"-1 1/2")	195,0/212,5	117	86	103,5	95	85	108

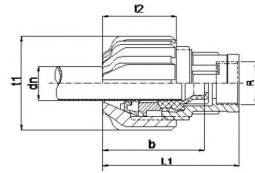

UNIVERSAL FEMALE ADAPTER /
ENLACE ROSCA HEMBRA UNIVERSAL

CODE	dn	R	L1 (max/min)	t1	t2	b (max)
ST720020	15-21 (3/8"-1/2")	1/2"	78,5/85,5	55	44	58
ST720021	15-21 (3/8"-1/2")	3/4"	79,5/86,5	55	44	58
ST720022	15-21 (3/8"-1/2")	1"	82,5/89,5	55	44	58
ST720025	21-27 (1/2"- 3/4")	3/4"	85,0/92,5	64,5	46	61
ST720026	21-27 (1/2"- 3/4")	1"	85,0/92,5	64,5	46	61
ST720027	21-27 (1/2"- 3/4")	1 1/4"	91,0/98,5	64,5	46	61
ST720032	27-35 (3/4 - 1")	1"	93,0/107,5	80	55	74,5
ST720033	27-35 (3/4 - 1")	1 1/4"	105,0/119,5	80	55	74,5
ST720034	27-35 (3/4 - 1")	1 1/2"	105,0/119,5	80	55	74,5
ST720041	35-50(1 1/4"-1 1/2")	1 1/2"	126,5/144,0	95	85	108

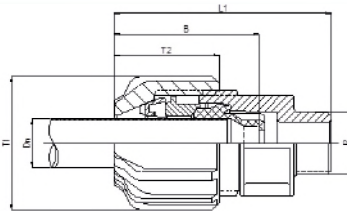

UNIVERSAL MALE ADAPTER /
ENLACE ROSCA MACHO UNIVERSAL

CODE	Dn	R	L1 (max/min)	t1	t2	b (max)
ST721020	15-21 (3/8"-1/2")	1/2"	76,5/83,5	55	44	58
ST721021	15-21 (3/8"-1/2")	3/4"	78,0/85,0	55	44	58
ST721022	15-21 (3/8"-1/2")	1"	80,5/87,5	55	44	58
ST721025	21-27 (1/2"- 3/4")	3/4"	81,0/88,5	64,5	46	61
ST721026	21-27 (1/2"- 3/4")	1"	83,5/90,5	64,5	46	61
ST721027	21-27 (1/2"- 3/4")	1 1/4"	84,5/92,0	64,5	46	61
ST721032	27-35 (3/4 - 1")	1"	92,0/99,5	80	55	74,5
ST721033	27-35 (3/4 - 1")	1 1/4"	91,5/106,0	80	55	74,5
ST721034	27-35 (3/4 - 1")	1 1/2"	92,0/99,5	80	55	74,5
ST721040	35-50(1 1/4"-1 1/2")	1 1/4"	109,5/127,0	95	85	108
ST721041	35-50(1 1/4"-1 1/2")	1 1/2"	112,5/130	95	85	108
ST721042	35-50(1 1/4"-1 1/2")	2"	113,5/131,0	95	85	108

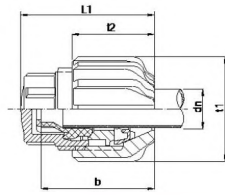

UNIVERSAL END CAP /
TAPÓN UNIVERSAL

CODE	dn	L1 (max/min)	t1	t2	b (max)
ST722020	15-21 (3/8"-1/2")	60,0/67,0	55	44	58
ST722025	21-27 (1/2"-3/4")	66,0/73,5	64,5	46	61
ST722032	27-35 (3/4 - 1")	73,0/87,5	80	55	74,5
ST722040	35-50(1 1/4"-1 1/2")	92,1/109,6	95	85	108

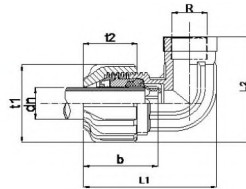

UNIVERSAL 90° ELBOW THREAD FEMALE /
CODO HEMBRA UNIVERSAL

CODE	dn	R	L1 (max/min)	L2	t1	t2	b (max)
ST723220	15-21 (3/8"-1/2")	1/2"	90,0/97,0	68	55	44	58
ST723221	15-21 (3/8"-1/2")	3/4"	90,5/97,5	74,5	55	44	58
ST723224	21-27 (1/2"-3/4")	1/2"	95,0/102,5	91	64,5	46	61
ST723225	21-27 (1/2"-3/4")	3/4"	95,0/102,5	91	64,5	46	61
ST723226	21-27 (1/2"-3/4")	1"	100/107	91	64,5	46	61
ST723227	21-27 (1/2"-3/4")	1 1/4"	95,0/102,5	91	64,5	46	61
ST723232	27-35 (3/4 - 1")	1"	114,0/128,5	103	80	55	74,5
ST723233	27-35 (3/4 - 1")	1 1/4"	119/136,5	103	80	55	74,5

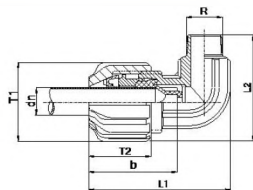

UNIVERSAL 90° ELBOW THREAD MALE /
CODO MACHO UNIVERSAL

CODE	dn	R	L1 (max/min)	L2	t1	t2	b (max)
ST723120	15-21 (3/8"-1/2")	1/2"	89,5/96,5	80	55	44	58
ST723121	15-21 (3/8"-1/2")	3/4"	90,5/97,5	75,5	55	44	58
ST723125	21-27 (1/2"-3/4")	3/4"	102,5/110,0	83,5	64,5	46	61
ST723126	21-27 (1/2"-3/4")	1"	99,5/107,0	92,5	64,5	46	61
ST723127	21-27 (1/2"-3/4")	1 1/4"	102,5/110,0	90	64,5	46	61
ST723132	27-35 (3/4 - 1")	1"	112,5/127,0	105	80	55	74,5
ST723133	27-35 (3/4 - 1")	1 1/4"	114,0/128,5	105	80	55	74,5

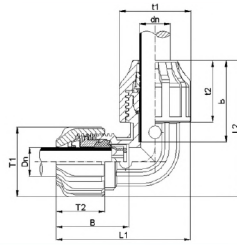

UNIVERSAL 90° ELBOW /
CODO 90° TRANSICIÓN UNIVERSAL

CODE	Dn	dn	L1 (max/min)	L2 (max/min)	T1	T2	B	t1	t2	b (max)
ST723019	15-21 (3/8"-1/2")	16	94,5/101,5	100,0	55	44	58	47	40,2	51
ST723020	15-21 (3/8"-1/2")	20	95,0/102,0	100,5	55	44	58	47	40,2	51
ST723021	15-21 (3/8"-1/2")	25	99,5/106,5	103,0	55	44	58	54	46	57
ST723025	21-27 (1/2"- 3/4")	25	104,0/111,5	115,0	64,5	46	61	54	46	57
ST723026	21-27 (1/2"- 3/4")	32	108,5/116,0	111,5	64,5	46	61	64,5	49	61
ST723033	27-35 (3/4 - 1")	40	125,5/140,0	138,5	80	55	74,5	80	58	76

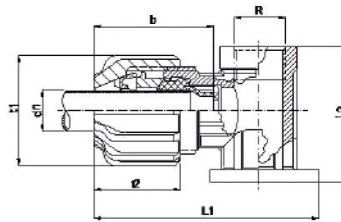

UNIVERSAL MALE ELBOW /
CODO MACHO UNIVERSAL

CODE	dn	R	L1 (max/min)	L2	t1	t2	b(max)
ST722121	15-21 (3/8"-1/2")	3/4"	107,5/95,5	66	55	44	58

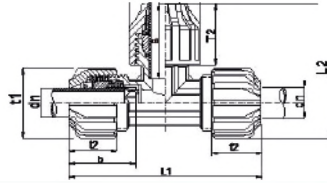

**UNIVERSAL TRANSITION 90° TEE /
TE TRANSICION UNIVERSAL**

CODE	dn	Dn	dn	L1 (max/min)	L2 (max/min)	t1	t2	b (max)	T1	T2	B (max)	t1	t2	b (max)
ST724002	15-21 (3/8"-1/2")	25	15-21 (3/8"-1/2")	142,5/156,5	46,8	55	44	58	54	46	58,5	55	44	58
ST724004	15-21 (3/8"-1/2")	20	15-21 (3/8"-1/2")	142,5/156,5	41,2	55	44	58	47	40,2	53	55	44	58
ST724006	21-27 (1/2"- 3/4")	32	21-27 (1/2"- 3/4")	153,0/160,5	112,5	64,5	46	61	64,5	49	61	64,5	46	61
ST724008	21-27 (1/2"- 3/4")	25	21-27 (1/2"- 3/4")	153,0/160,5	120,5	64,5	46	61	54	46	59	64,5	46	61
ST724012	27-35 (3/4 - 1")	40	27-35 (3/4 - 1")	172,5/201,5	139	80	55	74,5	80	58	76	80	55	74,5
ST724014	27-35 (3/4 - 1")	32	27-35 (3/4 - 1")	172,5/201,5	140	80	55	74,5	64,5	48,5	61	80	55	74,5

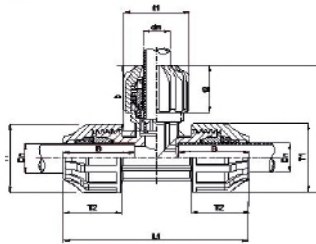

CODE	Dn	dn	Dn	L1 (max/min)	L2(max/min)	T1	T2	B (max)	t1	t2	b (max)	T1	T2	B (max)
ST724010	32	15-21 (3/8"-1/2")	32	159	118,0/125,0	64,5	48,5	61	55	44	58	64,5	48,5	61
ST724016	40	21-27 (1/2"- 3/4")	40	198,5	137,0/144,5	80	58	76	64,5	46	61	80	58	76

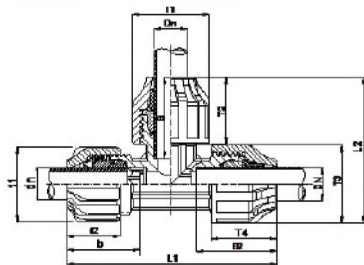

CODE	dn	Dn	DN	L1 (max/min)	L2 (max/min)	t1	t2	b (max)	T1	T2	B (max)	T3	T4	B2 (max)
ST724001	15-21 (3/8"-1/2")	25	25	145,0/152,0	45,8	55	44	58	54	46	58,5	54	46	58,5
ST724003	15-21 (3/8"-1/2")	20	25	145,0/152,0	40,2	55	44	58	47	40,2	53	54	46	58,5
ST724005	21-27 (1/2"- 3/4")	32	32	157,0/164,5	112,5	64,5	46	61	64,5	49	61	64,5	49	61
ST724007	21-27 (1/2"- 3/4")	25	32	157,0/164,5	120,5	64,5	46	61	54	46	59	64,5	49	61
ST724011	27-35 (3/4 - 1")	40	40	185,5/200,0	139	80	55	74,5	80	58	76	80	58	76
ST724013	27-35 (3/4 - 1")	32	40	185,5/200,0	140	80	55	74,5	64,5	48,5	61	80	58	76

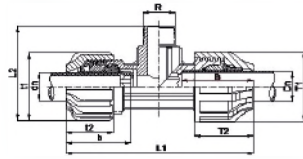

UNIVERSAL TRANSITION 90° TEE MALE OFFTAKE /
TE MACHO TRANSICION UNIVERSAL

CODE	dn	DN	R	L1 (max/min)	L2	t1	t2	b (max)	T1	T2	B
ST724220	15-21 (3/8"-1/2")	25	1/2"	145,0/152	71	55	44	58	47	40,2	51
ST724221	15-21 (3/8"-1/2")	25	3/4"	145,0/152	73,5	55	44	58	54	46	57
ST724225	21-27 (1/2"- 3/4")	32	3/4"	157,0/164,5	87,5	64,5	46	61	64,5	49	61
ST724226	21-27 (1/2"- 3/4")	32	1"	157,0/164,5	93	64,5	46	61	64,5	49	61
ST724227	21-27 (1/2"- 3/4")	32	1 1/4"	157,0/164,5	94,5	64,5	46	61	64,5	49	61
ST724233	27-35 (3/4 - 1")	40	1 1/4"	185,0/199,5	106	80	55	74,5	80	58	76

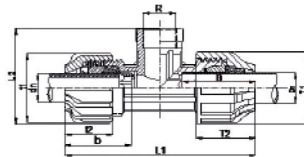

UNIVERSAL TRANSITION 90° TEE FEMALE /
TE HEMBRA TRANSICION UNIVERSAL

CODE	dn	Dn	R	L1 (max/min)	L2	t1	t2	b (max)	T1	T2	B
ST724120	15-21 (3/8"-1/2")	25	1/2"	147,5/154,5	67,5	55	44	58	54	46	57
ST724121	15-21 (3/8"-1/2")	25	3/4"	145,5/152,5	75,0	55	44	58	54	46	57
ST724124	21-27 (1/2"- 3/4")	32	1/2"	157,0/164,5	91	64,5	46	61	64,5	49	61
ST724125	21-27 (1/2"- 3/4")	32	3/4"	157,0/164,5	91,0	64,5	46	61	64,5	49	61
ST724126	21-27 (1/2"- 3/4")	32	1"	157,0/164,5	91,0	64,5	46	61	64,5	49	61
ST724127	21-27 (1/2"- 3/4")	32	1 1/4"	157,0/164,5	89,5	64,5	46	61	64,5	49	61
ST724132	27-35 (3/4 - 1")	40	1"	186,0/200,5	102,5	80	55	74,5	80	58	76
ST724133	27-35 (3/4 - 1")	40	1 1/4"	185,5/200,0	102,0	80	55	74,5	80	58	76

PP Valves / Válvulas de PP

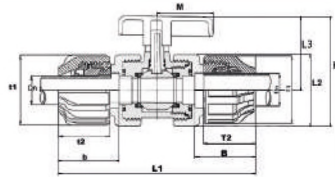

PE-UNIVERSAL COMPRESSION /
COMPRESIÓN PE-UNIVERSAL

CODE	dn	Dn	L1	L2	L3	H	M	T1	T2	t1	t2	B/b
ST141024CU	15-21 (3/8"-1/2")	25	182	67	70	103	53	54	46	55	44	56/54
ST141025CU	21-27 (1/2"-3/4")		187	67	70	103	53	54	46	64,5	49	56/59
ST141031CU	15-21 (3/8"-1/2")	32	183	67	70	103	53	64,5	49	55	44	59/54
ST141032CU	21-27 (1/2"-3/4")		188	67	92	139	64	64,5	49	64,5	49	59
ST141040CU	27-35 (3/4"-1")	40	229	93	92	139	64	80	58	80	55	70/67
ST141050CU	35-50 (1 1/4"-1 1/2")	50	275	93	92	139	64	94	70	95	85	84/99

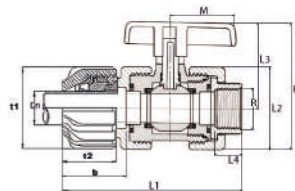

UNIVERSAL COMPRESSION
FEMALE BSP THREAD /
COMPRESION UNIVERSAL
ROSCA HEMBRA BSP

CODE	dn	R	L1	L2	L3	L4	H	M	t1	t2	b
ST141025UM	15-21 (3/8"-1/2")	3/4"	143,5	67	70	16	103	53	55	44	54
ST141030UM	15-21 (3/8"-1/2")	1"	143,5	67	70	19	103	53	55	44	54
ST141031UM	21-27 (1/2"-3/4")	3/4"	151,5	67	70	16	139	64	64,5	49	59
ST141032UM	21-27 (1/2"-3/4")	1"	151,5	67	70	19	139	64	64,5	49	59
ST141040UM	27-35 (3/4"-1")	1 1/4"	186	93	92	21	139	64	80	55	67
ST141041UM	27-35 (3/4"-1")	1 1/2"	186	93	92	22	139	64	80	55	67
ST141049UM	35-50 (1 1/4"-1 1/2")	1 1/4"	222	93	92	21	139	64	95	85	99
ST141050UM	35-50 (1 1/4"-1 1/2")	1 1/2"	222	93	92	22	139	64	95	85	99

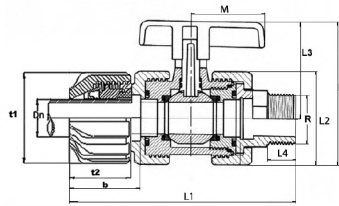

**UNIVERSAL COMPRESSION
MALE BSP THREAD /
COMPRESION UNIVERSAL
ROSCA MACHO BSP**

CODE	dn	R	L1	L2	L3	L4	H	M	t1	t2	b
ST142025UM	15-21 (3/8"-1/2")	3/4"	162	67	70	16,5	103	53	55	44	54
ST142030UM	15-21 (3/8"-1/2")	1"	162	67	70	19	103	53	55	44	54
ST142031UM	21-27 (1/2"-3/4")	3/4"	169,5	67	70	16,5	139	64	64,5	49	59
ST142032UM	21-27 (1/2"-3/4")	1"	169,5	67	70	19	139	64	64,5	49	59
ST142040UM	27-35 (3/4"-1")	1 1/4"	203,5	93	92	21	139	64	80	55	67
ST142041UM	27-35 (3/4"-1")	1 1/2"	203,5	93	92	21	139	64	80	55	67
ST142049UM	35-50 (1 1/4"-1 1/2")	1 1/4"	238,5	93	92	21	139	64	95	85	99
ST142050UM	35-50 (1 1/4"-1 1/2")	1 1/2"	238,5	93	92	21	139	64	95	85	99

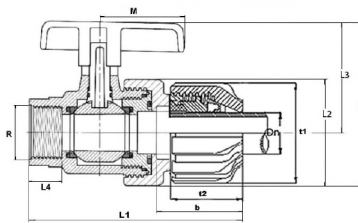

**UNIVERSAL COMPRESSION
FEMALE BSP THREAD /
COMPRESION UNIVERSAL
ROSCA HEMBRA BSP**

CODE	dn	R	L1	L2	L3	L4	H	M	t1	t2	b
ST146020UF	15-21 (3/8"-1/2")	3/4"	131	67	70	16	103	53	55	44	54
ST146025UF	21-27 (1/2"-3/4")	1"	139	67	70	19	103	64	64,5	49	59
ST146032UF	27-35 (3/4"-1")	1 1/4"	169	93	92	21	139	64	80	55	67
ST146040UF	35-50 (1 1/4"-1 1/2")	1 1/2"	204,5	93	92	22	139	64	95	85	99

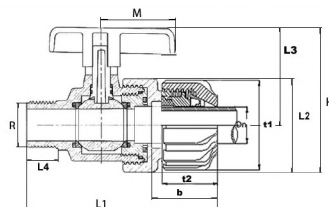

**UNIVERSAL COMPRESSION
MALE BSP THREAD /
COMPRESION UNIVERSAL
ROSCA MACHO BSP**

CODE	dn	R	L1	L2	L3	L4	H	M	t1	t2	b
ST147020UM	15-21 (3/8"-1/2")	3/4"	140	67	70	16	103	53	55	44	54
ST147025UM	21-27 (1/2"-3/4")	1"	146	67	70	19	103	64	64,5	49	59
ST147032UM	27-35 (3/4"-1")	1 1/4"	179	93	92	21	139	64	80	55	67
ST147040UM	35-50 (1 1/4"-1 1/2")	1 1/2"	214,5	93	92	22	139	64	95	85	99